

# SWG3 PRODUCTION SPEC 2024-2025

Contact	<a href="mailto:tech@swg3.tv">tech@swg3.tv</a> / <a href="mailto:dave@swg3.tv">dave@swg3.tv</a>
Department	Tech / Production
Last updated	August 2025





# CONTENTS

Key Information	Page 3
Environmental Policy	Page 4
<b>SWG3 Complex</b>	
SWG3 Ground Floor Map	Page 5
SWG3 Upper Floor Maps	Page 6
<b>SWG3 Spaces</b>	
Galvanizers Floor Plan	Page 7—8
Galvanizers Tech Spec	Page 9
TV Studio Floor Plan	Page 10
TV Studio Tech Spec	Page 11
Warehouse Floor Plan	Page 12
Warehouse Tech Spec	Page 13
Poetry Club Floor Plan	Page 14
Poetry Club Tech Spec	Page 15
<b>SWG3 Local Area</b>	
SWG3 Local Area Map	Page 16





# KEY INFORMATION

## GALVANIZERS AND TV STUDIO BACKSTAGE AREA

(Galvanizers has dressing room priority)

- 3 x Dressing Rooms
- 1 x Production Office
- 4 x Toilets
- 4 x Showers

## WAREHOUSE AND POETRY CLUB BACKSTAGE AREA

(Warehouse has dressing room priority)

- 1 x Production office
- 2 x Dressing rooms
- 1 x Shower in main dressing room
- 1 x Toilet in main dressing room

## PARKING INFORMATION

Please email [tech@swg3.tv](mailto:tech@swg3.tv) for parking information in regards to your show. We can offer 32/3 Ceeform power for buses in 3 different locations depending on venue activity.

## NON-UK POWER

We have no European or US Power Adapters. We can only provide UK 230v Power.

## AVAILABLE MICROPHONES PER ROOM

- 2 x ShureB91
- 2 x ShureB52
- 4 x ShureSM57
- 8 x ShureSM58
- 4 x SennheiserE604
- 2 x SennheiserE609
- 3 x AKG 430
- 3 x ATM 450
- 6 x Mono KT DI
- 2 x Stereo KT DI

## AVAILABLE DJ BACKLINE PER ROOM

- 1 x Pioneer DJM900 Nexus Mixer or Allen & Heath Xone92 Mixer
- 2 x Pioneer CDJ2000 Nexus CDJs
- 2 x Technics 1210 MkII Turntables
- 2 x Ortofon DJ Catridges
- 1 x Netgear GS105 LAN Hub

## ADDITIONAL DJ BACKLINE

- 1 x Sennheiser E835 G4 Radio Mic
- 1 x DJM900NX2
- 4 x CDJ2000NX2

# ADDITIONAL PROMOTER COSTS

## STANDARD GIG LOAD IN TIMES

Galvanizers	12pm (£65+VAT per hour for early load in)
TV Studio	1pm (£65+VAT per hour for early load in)
Warehouse	3pm (£45+VAT per hour for early load in)
Poetry Club	4pm (£17+VAT per hour for early load in)

## MERCH CONCESSION

SWG3 no longer charges Merch Concession

## TOWELS

Towels can be supplied by the venue for £2.50 + VAT per towel.

## CONFETTI CLEAN UP

Confetti clean up fee is £250 + VAT.

## EARLY ACCESS

Early dressing room access can be arranged for £20+vat per hour

## BUS PARKING

Parking on site for non-show days can be arranged for £80+vat Per Vehicle Per Day



# ENVIRONMENTAL POLICY

Touring and events have a significant environmental impact. At SWG3, we're committed to minimising the impact of our venue and to do this we need your help. We encourage you to think about sustainability in advance of your event as this will make the biggest difference. We want to work with you to minimise waste and reduce carbon emissions where possible by following these guidelines.

We're also open to hearing your ideas about what we can do to make your event more sustainable. If you have any questions, please contact us at [hannah@swg3.tv](mailto:hannah@swg3.tv).

## OUR AIMS

- Power events efficiently with clean, renewable energy
- Redesign events to utilise sustainable materials and be waste free
- Source food sustainably and eliminate food waste
- Move goods and equipment efficiently and transition to zero emissions logistics
- Work with and influence partners in the travel sector to reduce and mitigate the emissions of travel to events

## WASTE AND RECYCLING

- Read and familiarise yourself with the SWG3 Sustainability Policy and the SWG3 Recycling Guide and understand how they relate to your event.
- Make best efforts to design single use items out of your events, especially plastic. Where single use items are required, it's your responsibility to reuse, recycle or dispose of them properly.
- Take responsibility for your own waste. SWG3 only deals with customer waste, and we operate an additional charge to process waste from tour buses and dressing rooms. Recycle waste in our recycling bins located throughout the venue.

## TRAVEL

- Encourage visitors to travel to the venue using sustainable transport options where possible. We provide bike storage onsite and have information about public transport routes on our website.

## CATERING

- Use a local caterer and order plant-based, seasonal food that does not require disposable cutlery or packaging where possible.
- Avoid over catering by encouraging guests to RSVP with dietary requirements.
- Please use reusable cups and water bottles where possible. All taps onsite are drinking water safe.

## ENERGY

- Reduce energy use by switching off lights and temperature controls when not in use.
- Keep heating and air conditioning in the range of 21-23°C to maximise efficiency.

## PRODUCTION AND OTHER

- Consider the design and production of your event to make it as energy efficient as possible.
- Discourage visitors from printing their tickets and switch to mobile ticket options.
- Adhere to our No Poster Policy. Instead, you can use our digital screens for advertising events.
- Please be aware that we charge an additional fee of £250 for the use of confetti, propane and CO2. This is due to the adverse effects it has on the environment and our ventilation system.
- Any materials and supplies should be sourced as sustainably, locally and ethically as possible. If you require any help or information on local suppliers, please contact us.

## AFTER THE EVENT

- Find ways to repurpose leftover event materials through websites such as Event Cycle.
- We operate a Pack-In/Pack-Out Policy which includes penalties for creating excessive waste. Please ensure the venue is left as you found it.



**FIND OUT  
MORE**

[swg3.tv/explore/going-net-zero/](https://swg3.tv/explore/going-net-zero/)



SWG3 COMPLEX  
GROUND LEVEL



SWG3 COMPLEX  
LEVEL ONE

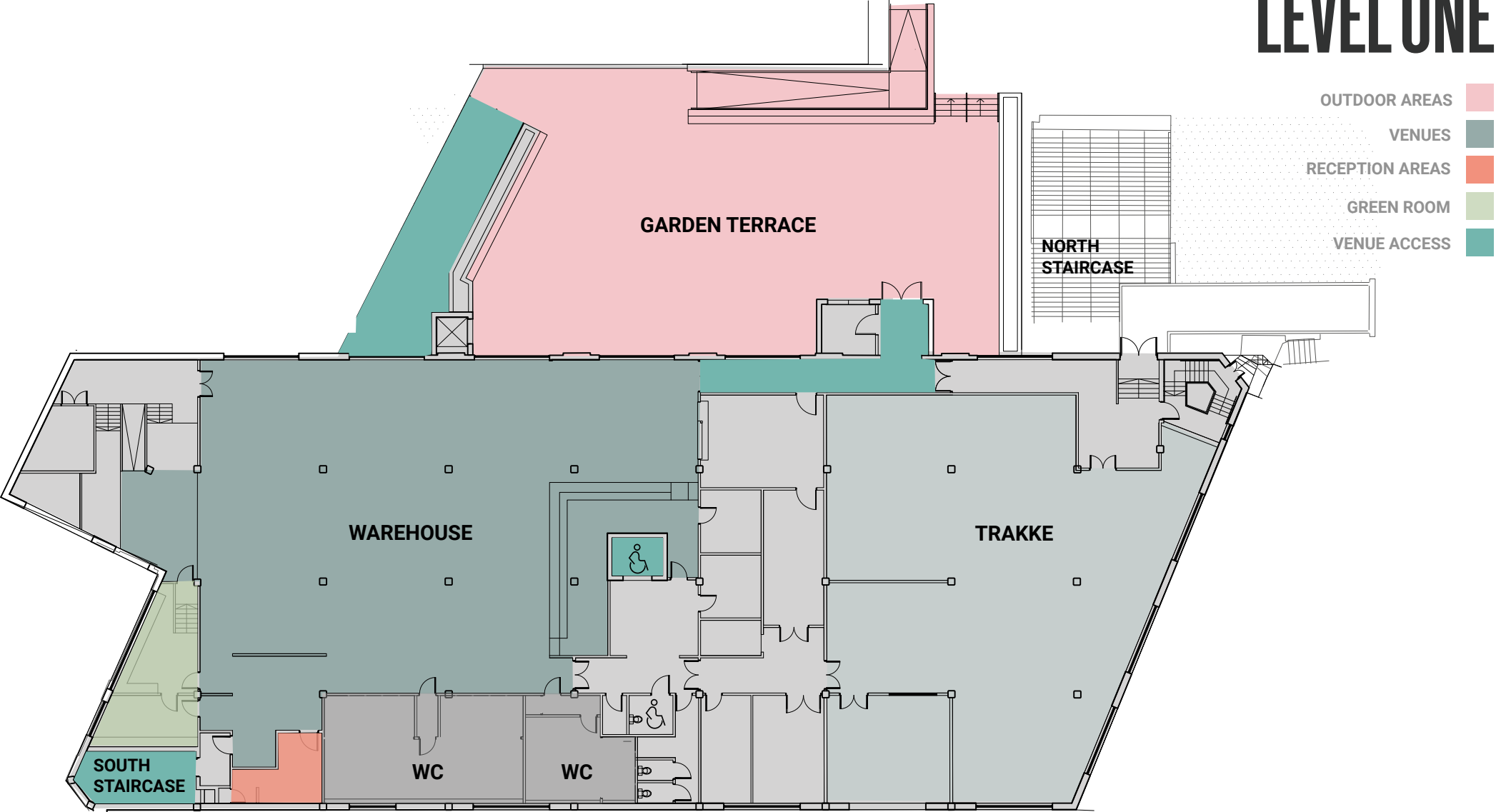



MEASUREMENTS  
GALVANIZERS

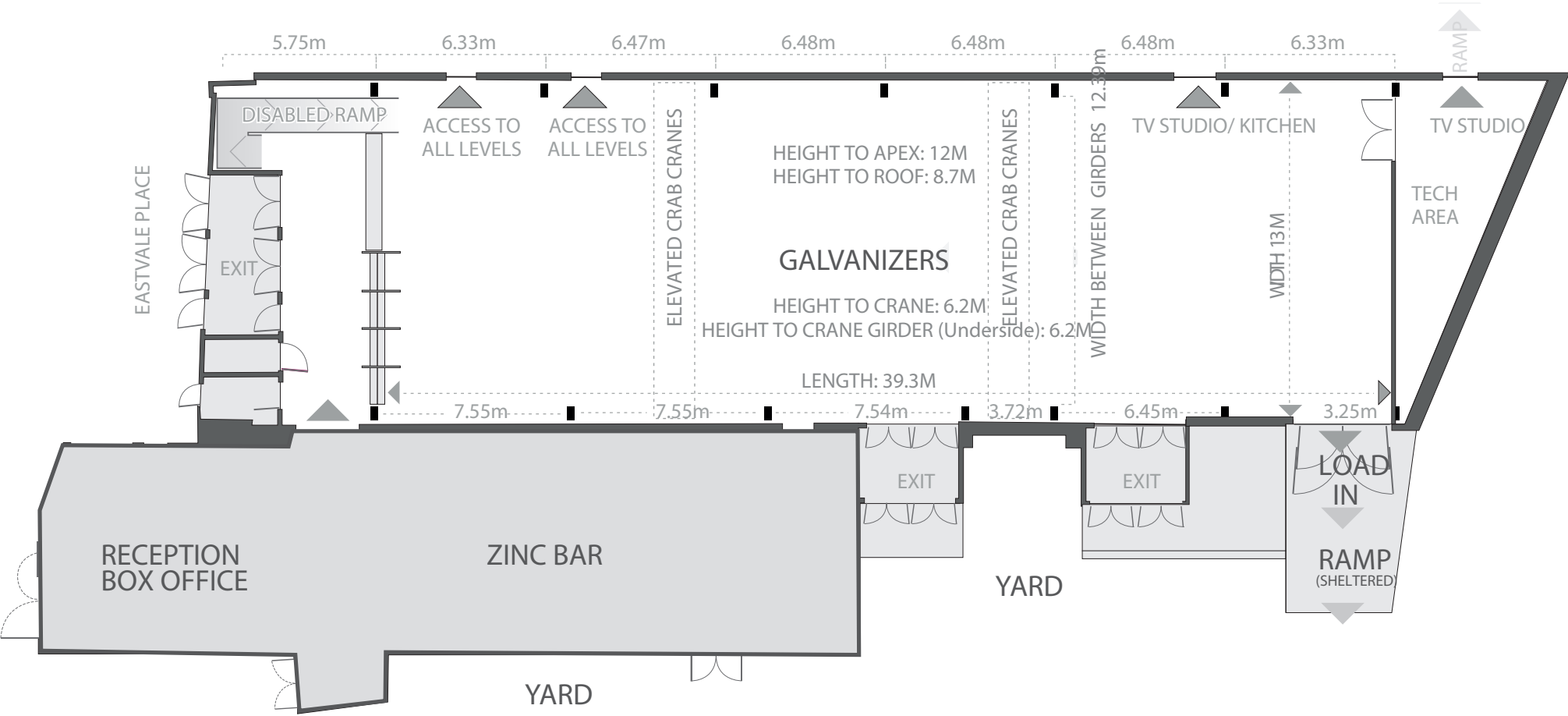



FLOOR PLAN  
GALVANIZERS

Standing	1250
Seated	600
Dinner	500
Stage width	9.8m (32ft)
Stage depth	6.1m (20ft)
Stage height	1.5m (4.9ft)
Clearance	4.5m

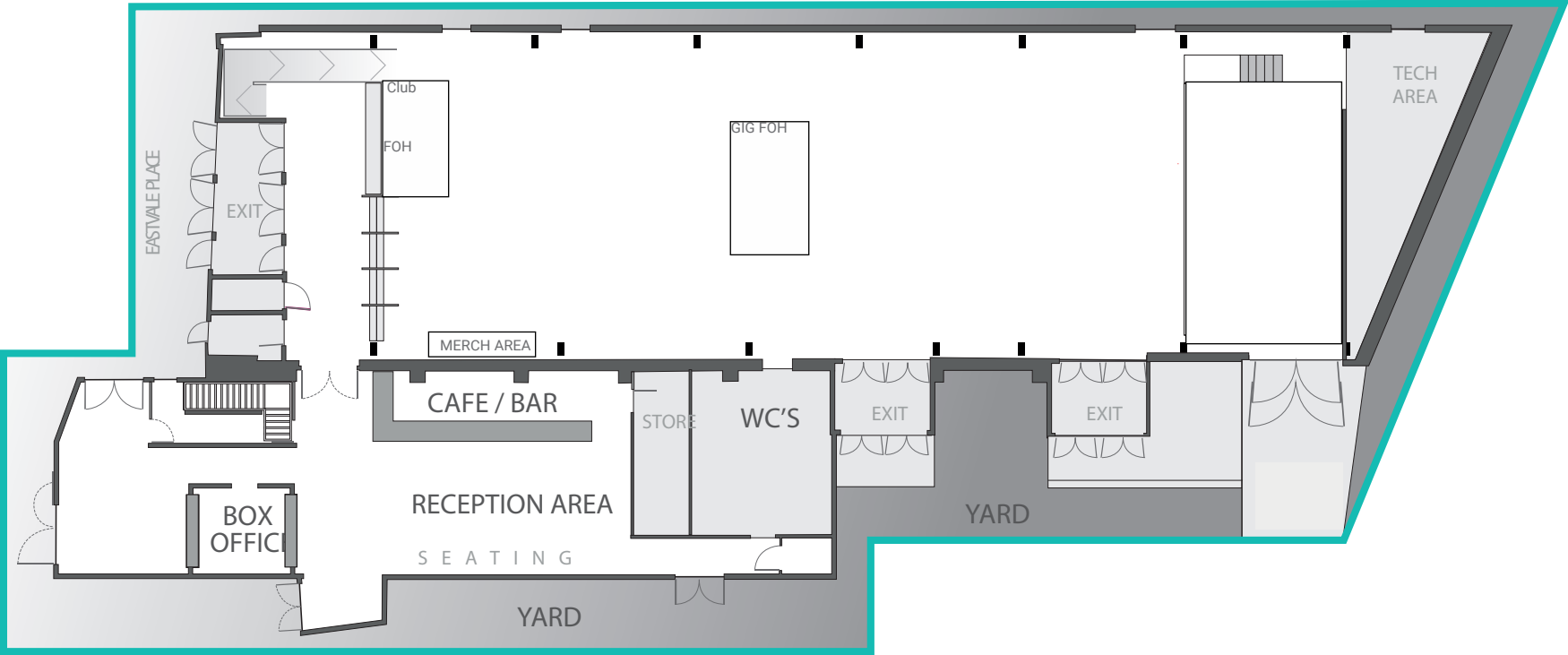





## TECH SPEC

# GALVANIZERS

### PA

D&B V Series Line Array (Array Processed) consisting of:  
6 x D&B V8 Per Side  
10 x D&B V-SUB Array  
4 x D&B Y7P Front Fill  
2 x D&B V7P Delays  
5 x D&B D80 Amplifiers

### MONITORS (LIVE)

10 x D&B M4 Wedges  
2 x D&B B6 Subwoofers  
4 x D&B D12 Amplifiers

### MONITORS (CLUB)

4 x B6 Subwoofer  
2 x M4 Tops  
1 x D&B D80 Amplifier

### CONSOLES

2 x Midas HD-96  
2 x Midas DL251 Stage Box  
4 x Cat5e Multicore (House Desk)  
1 x 32A Power for FOH

### LIGHTING

8 x Robe Mega Pointe  
12 x Robe Spider  
6 x Clay Paky Stormy CC  
8 x TMB 2-Cell Molefay  
1 x Chamsys MQ80 Lighting Console  
1 x Chamsys Extra Wing  
3 x 5 Pin Hardline DMX for house control  
1 x Available Cat5e Line  
1 x 16a Power available at FOH

### RIGGING

Please email [tech@swg3.tv](mailto:tech@swg3.tv) for Rigging Plan.

### STAGE TRUSSING

1x 10m Milos M390 Rear Truss on 2 x 1t GIS DB Motors  
1x 10m Milos M290 Rear Truss on 2 x 500kg GIS DB Motors  
1x 8m Milos M390 Front Truss on 2 x 500kg GIS DB Motors  
We have no Mid Truss for the stage  
Backdrop Bar is 10m wide 5.5m drop to stage

### POWER

Visiting Lighting Power 125/3 or 2 x 63/3  
Visiting Audio Power 1 x 32/3  
13a UK Power available for the stage and at FOH

### NOISE RESTRICTION

We have TenEazy Noise monitoring within the Galvanizers.  
Our limit within the room at FOH is 100dba over 15 Minutes.

We have noise monitoring at the site boundary with is a limit  
of 80db peak @ 63hz Octave band.



FLOOR PLAN  
TV STUDIO

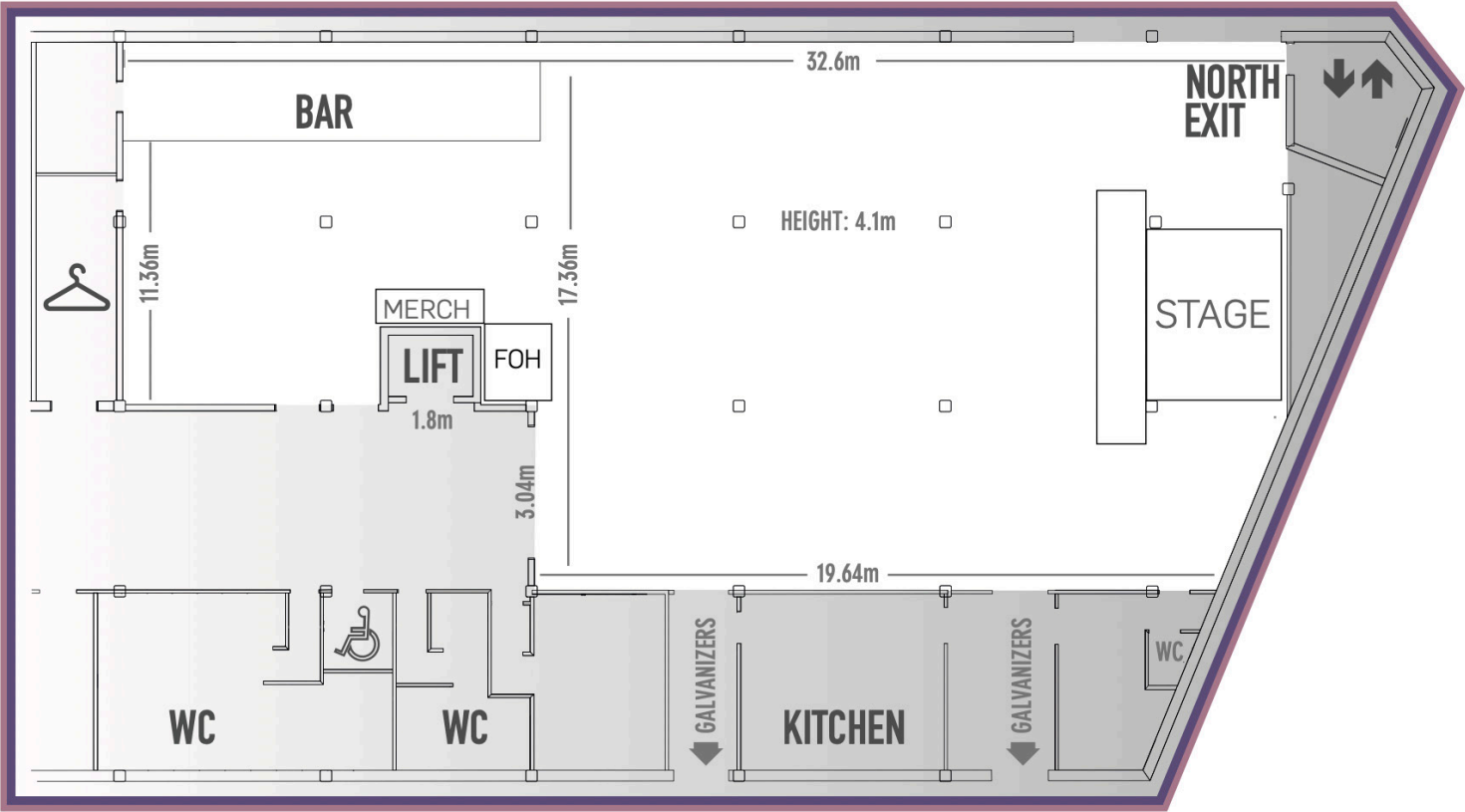

Standing	1000
Seated	300
Upstage width	4.9m (16ft)
Upstage depth	3.6m (12ft)
Downstage width	7.3m (24ft)
Downstage depth	1.82m (6ft)
Height from floor to stage	1m
Height from stage to ceiling	2.7m
10 x 1m sections of steel mojo	



# TECH SPEC TV STUDIO

## PA

D&B V Series Line Array  
2 x D&B V8 Per Side  
2 x D&B V12 Per Side  
8 x D&B V-SUB  
2 x D&B Q7 Front Fill  
2 x D&B Y7P Delays  
2 x D&B 30D Amplifiers  
1 x D&B D80 Amplifier

## MONITORS (LIVE)

8 x D&B M4 Wedges  
2 x D&B B6 Subwoofers  
4 x D&B D12 Amplifiers

## MONITORS (CLUB)

2 x D&B B6 Subwoofer  
2 x D&B M4 Monitors  
1 x D&B D80 Amplifier

## CONSOLES

2 x Midas HD-96  
Midas DL251 Stage Box x 2  
2 x Cat5e Multicore for House Desk

## LIGHTING

12 x Chauvet Rogue R1 Spots  
12 x Chauvet Rogue R2 Washes  
4 x Martin Atomic 3000  
1 x Chamsys MQ80 Lighting Console  
1 x 5Pin DMX Line to FOH for House  
1 x 5Pin DMX Line to FOH for Touring

## POWER

Available for touring production:

1 x 63/3 Ceeform  
1 x 32/3 Ceeform  
2 x 16a Available at FOH  
13a UK power available at Stage and FOH

## RIGGING

Email [tech@swg3.tv](mailto:tech@swg3.tv) for rigging plot  
6 x Milos Quatro M290V Truss (200kg UDL)  
57 x Scaffold Bars (50kg UDL)  
2 x PA Rigging Point (200kg UDL)  
Backdrop Wire is 4.8m wide and 2.7m drop to stage



# FLOOR PLAN WAREHOUSE

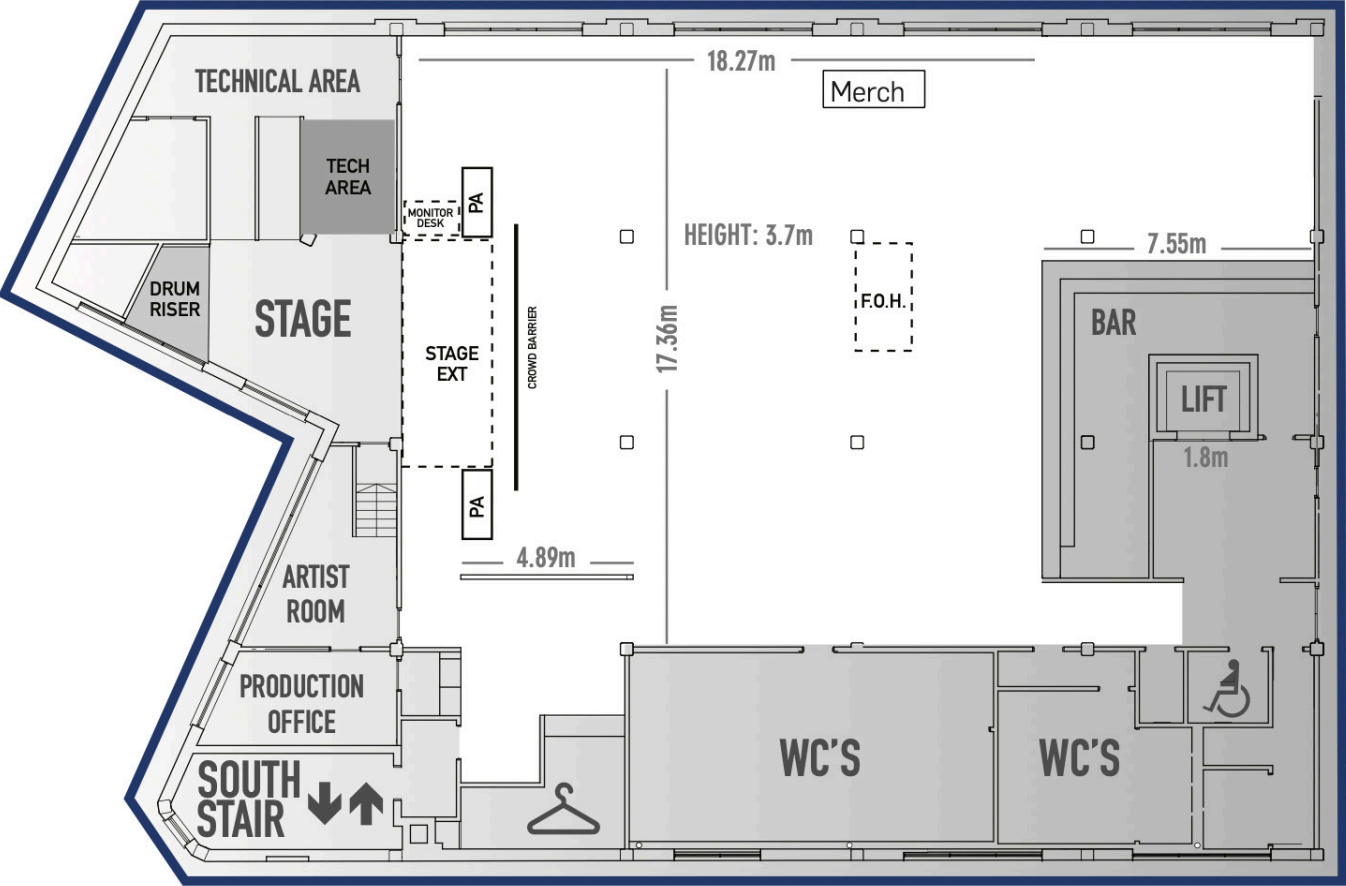

Standing	500
Seated	180
Upstage width	5.5m
Upstage depth	3m
Downstage width	7.3m
Downstage depth	2.4m
Height from floor to stage	1m
Height from stage to ceiling	2.7m
Height from Stage to Roof Beams	2.25m
8 x 1m sections of steel jojo	



# TECH SPEC WAREHOUSE

## PA

D&B Q Series PA consisting of:

- 8 x D&B Q1 Tops
- 4 x D&B B2 Subs
- 4 x D&B Q Sub
- 2 x D&B Q7
- 6 x D&B D12

## CONSOLE

- 1 X ALLEN & HEATH SQ6
- 1 x Allen & Heath GX4816 Stage Box
- 3 x CAT5e Multicore

## MONITORS (LIVE)

- 6 x D&B M4 Wedges
- 4 x D&B D12 Amplifiers
- 1 x D&B B6 Subwoofers

## MONITORS (CLUB)

- 2 x D&B B6 Subwoofers
- 2 x D&B M4 Monitors

## LIGHTING

- 8 x Chauvet Rogue R1 Spots
- 8 x Chauvet Rogue R2 Washes
- 1 x Martin Atomic 3000
- 1 x Chamsys PC Wing and Touch Screen laptop

## POWER

- 1 x 32a Three Phase Socket (Touring)
- 2 x 32a Socket (House Equipment)
- 5 x 16a Socket (House Equipment)

13a and 16a Power Available on stage and at FOH for touring production.

## RIGGING

- email tech@swg3.tv for rigging plan
- 4 x 5m Trilite Truss (120kg UDL)
- 2 x 3m Trilite Truss (90kg UDL)
- 2 x 2m Truss (60kg UDL)
- 20 x Scaffold Bars (40kg UDL)
- 2 x PA Rigging Point (300kg UDL)

## LOAD IN

Load in for the Warehouse is conducted through the lift from the ground floor. For equipment that is larger than these dimensions we have a Production Entrance to the north of the building. 2.4m wide x 2.4m high (8'x 8').

Warehouse lift dimensions

Door	1.1 m wide x 1.97m high (3'7" x 6'6")
Carriage	1.9m wide x 1.6m deep x 1.9m high (6'4" x 5'6" x 6'6")
Max load	800kg



FLOOR PLAN  
THE POETRY CLUB

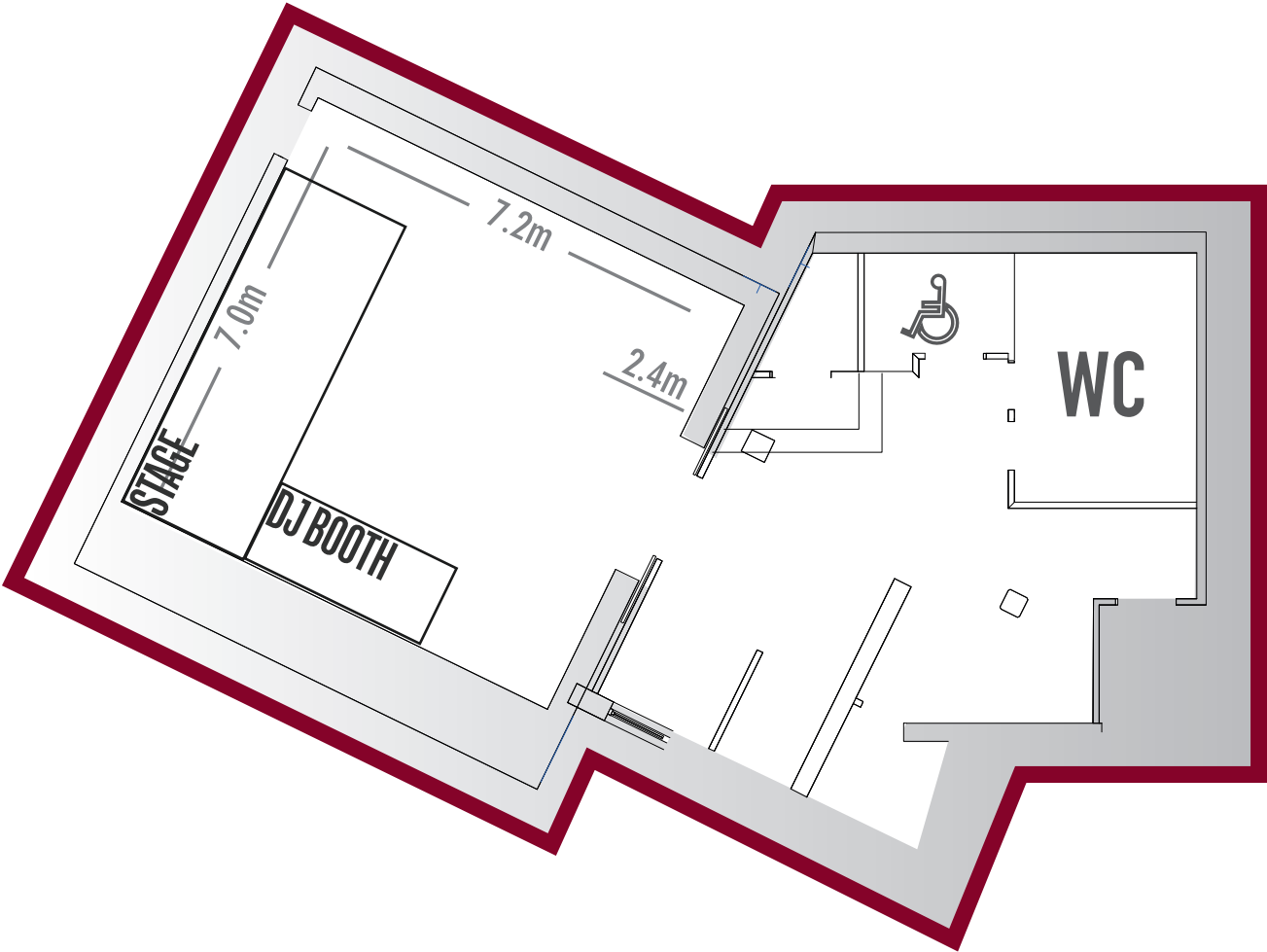

Club nights	129
Gigs	100
Seated	40
Stage width	5.2m
Stage depth	1.8m
Stage height	0.24m





TECH SPEC

# THE POETRY CLUB

## FOH SYSTEM

- 2 x D&B C6 Top
- 4 x D&B C4 Sub
- 2 x D&B D12
- 2 x EV Evid 4.2 (Bar Area)
- 1 x Midas M32R (16Ch)
- 4 x Yamaha DXR12 Monitors

## LIGHTING

- 1 x Chamsys Touchscreen PC
- 6 x Chauvet Intimidator Trio
- 2 x Lanta Tri LED Par Cans
- 6 x Pulsar ChromaZone CZ6 LED Lights
- 4 x Lanta Saturn Quad Beam
- 1 x Martin Atomic Strobe
- 1 x Look Solutions Unique Hazer
- 1 x Antari Z-800 Smoke Machine (Train)
- 2 x Optikinetics Solar 250 (Bar)

## VIDEO

- 1 x 100" 16:9 Projector Screen (Stage)
- 1 x OPTOMA ZH403

## POWER

- 1 x 16a Socket (DJ Booth)
- 4 x Dual Gang 13a Sockets (DJ Booth)
- 1 x Dual gang 13a Socket (Mezzanine)

## RIGGING

- 6 x Milos Quatro M290V Truss (200kg UDL)
- 5 x Scaffold Bars (40kg UDL)

